

EXISTING GRVEL FOOTPATH OFF GREEN

TARMAC FOOTPATH

MONKTON LANE

TARMAC FOOTPATH

WOODS

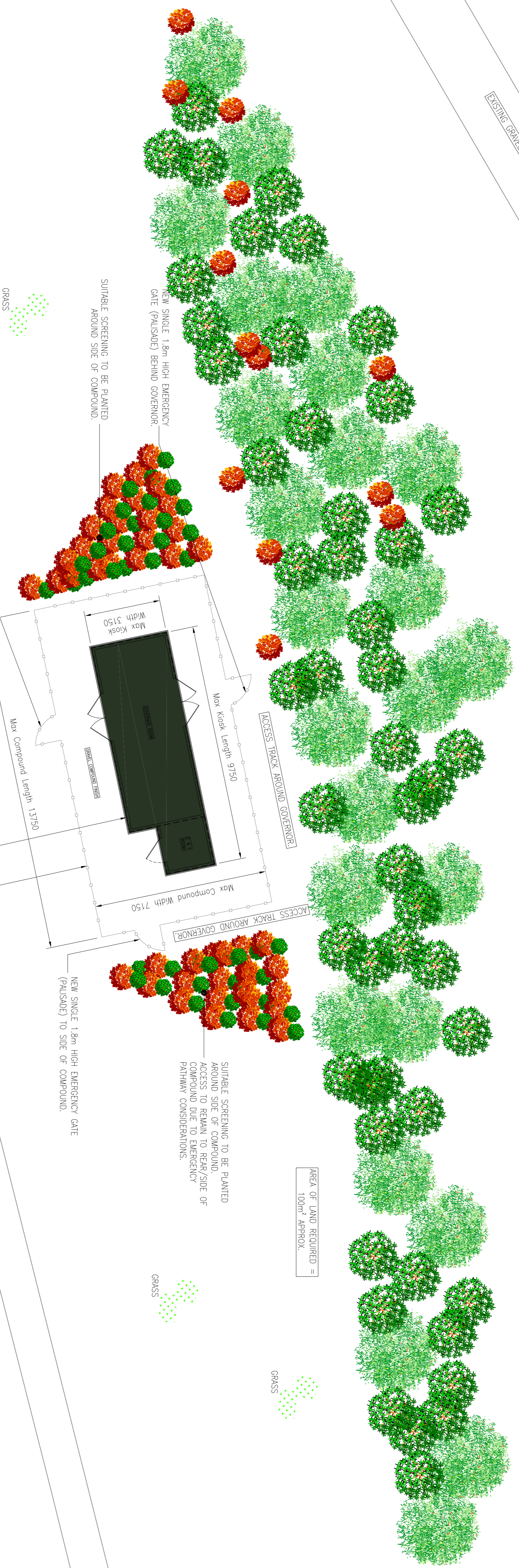

7750x3000x2500 GRP GOVERNOR KIOSK WITH ADJOINING 2000x2000x2500H GRP E & I KIOSK TALL PAINTED RAL 6007 (GREEN) ON 250mm THK R.C. BASE. (DETAILS T.B.C.)

13750x7000x1800mm HIGH GATED PALISADE COMPOUND TO BE PAINTED WHITE RAL 6007 (GREEN) TO MATCH GOVERNOR KIOSK.

AREA OF LAND REQUIRED = 100m<sup>2</sup> APPROX.

PROPOSED G.A

SCALE 1:100

- NOTES
- This drawing is to be read in conjunction with the following drawings:
- 50128/P/101 : Site Location Plan
  - 50128/P/102 : Existing G.A
  - 50128/P/104 : South & West Elevations
  - 50128/P/105 : North & East Elevations
  - 50128/P/106 : Proposed Housing Details

Rev	Date	Description	By	Ch
P1	01/09/15	ISSUED FOR PLANNING	DR	CH

© copyright

UVDB Registered

LINK-UP Registered via Audit

UKAS INTERTEK

**GGP CONSULT**

CONSULTING ENGINEERS  
PROJECT MANAGEMENT

Priority TEC Park  
Soxton Way, Hessle  
HULL HU13 9PB  
United Kingdom

Telephone 144 0482 627933  
Fax 144 0482 641736  
Email info@gppconsult.co.uk

Client

**Northern Gas Networks**

Job Title

GAS REINFORCEMENT SCHEME,  
MONKTON LANE,  
HEBBURN,  
TYNE & WEAR, NE31 2JG

Drawing Title

PLANNING DRAWINGS  
PROPOSED SITE G.A

Status		PLANNING	
Scale	SHOWN @ A1	Date	Sept 2015
Drawn By	LYNCE	Checked	DYI
		Approved	SHY

Dwg No.	50128/P/102	Rev	P1
---------	-------------	-----	----